



THE OKANAGAN

DUAL ZONE WINE & BEVERAGE COOLER



Available finishes

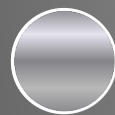

Stainless Steel
M4-D250SS



Black Steel
M4-D250BLS



Panel Ready
M4-D250PANR

Model No:

23 7/16" x 34 3/16" - 35" x 23 13/16"



KEY FEATURES

HETTICH® ZERO CLEARANCE HINGE

Slow-close articulating hinge for flush installation & field reversible door swing for added flexibility.

ECO-FRIENDLY HFO INSULATION

Advanced proprietary insulation formula improves energy efficiency and performance.

VARIABLE AIRFLOW TECHNOLOGY

Maintains a consistent temperature, adapting airflow to keep wines perfectly chilled.

DUAL COPPER EVAPORATORS

Copper is designed to deliver improved cooling efficiency, durability & lifespan.

UPPER ZONE

Capacity up to 16 wine bottles
Temperature Range: 3-20°C
(37.4-68°F)

LOWER ZONE

Capacity up to 57 cans &
12 wine bottles
Temperature Range: 3-20°C
(37.4-68°F)

ADDITIONAL FEATURES

- ✓ Dual carbon air filtration system
- ✓ Triple pane humidity-controlled & UV protected glass
- ✓ 90% extension ball bearing shelves
- ✓ Black flush kickplate with ornate design
- ✓ Minimalist intuitive UI with TFT display
- ✓ LED Stadium lighting
- ✓ Sabbath mode
- ✓ Demo mode
- ✓ Sleek stainless steel handle design



Construction & Operation

Built-in Installation	✓
Flush Mount Depth to Kickplate	✓
Noise Level (dBa)	< 38
Hettich® Soft Close Zero Clearance Hinge	✓
DOW DELTA-THERM™ High Density HFO Foam Insulation	✓
Custom Copper Evaporator	2
Embraco® Fixed Speed Compressor	✓
Energy Efficient Frost-Free Operation	✓
Marathon Variable Airflow Technology	✓
Door Ajar Chime	✓
Sabbath Mode	✓
Demo Mode	✓

Interior Features

High Definition TFT Display & Minimalistic Illuminated Control Panel	✓
Auto Gradual LED Interior Lighting	✓
90% Extension Ball Bearing Shelves	4
Wooden Shelf Trim	✓
Refillable High Flow Carbon Filter	2

UPC

809854002006



Exterior Fit & Finish

Reversible Door Swing (Factory Set RH)	✓
Triple Pane Humidity Controlled Ar Insulated Glass Door	✓
2 Layer Low-E UV Protected Glass	✓

Technical Specifications

Capacity (cu.ft. / L)	5.3/150
Capacity (wine bottles standard cans)	Up to 28 bottles Up to 57 cans
Energy Consumption (kwh/year)	134
ENERGY STAR® / NRCAN Certified	✓
Temperature Range	3-20°C
Refrigerant Type	R600A
Humidity Control Level	60%
Electrical	115V, 60Hz, 2A
Certification	CSA
Country of Origin	Canada

Product Dimensions*

W x H x D (mm)	595 x 868 - 888 x 604.45
W x H x D (inches)	23 7/16 x 34 3/16 - 35 x 23 13/16
Net Weight (kg)	68.8
Net Weight (lbs)	151.6

*Excludes panel

Product Dimensions

W x H x D (mm)	673 x 673 x 952.5
W x H x D (inches)	26 ½ x 26 ½ x 37 ½
Gross Weight (kg)	72.3
Gross Weight (lbs)	159.31

Note: This appliance is designed to accommodate custom cabinet panels (either full or frame-style) by mounting onto the aluminum frame surrounding the humidity-controlled glass window. Handle hardware & panel not included.

Cabinet Dimensions

Note: With legs fully retracted the minimum overall height is 34 3/16" [868.0mm] from top to bottom. The legs can be extended up to 13/16" [20.0mm] to make the unit taller.

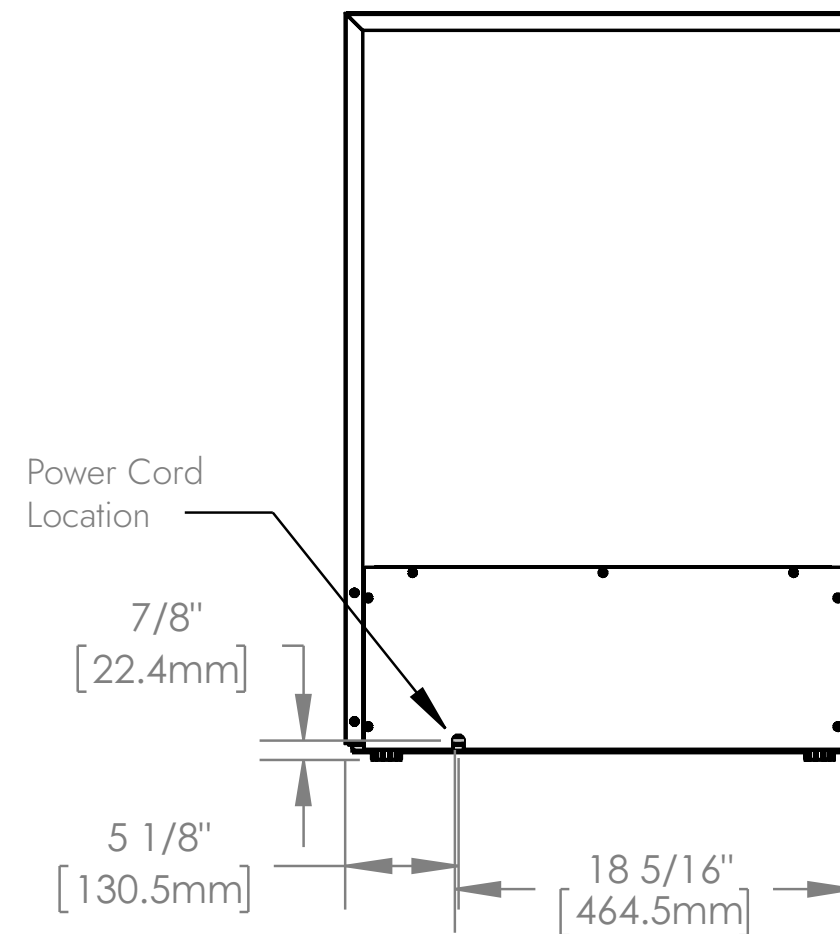
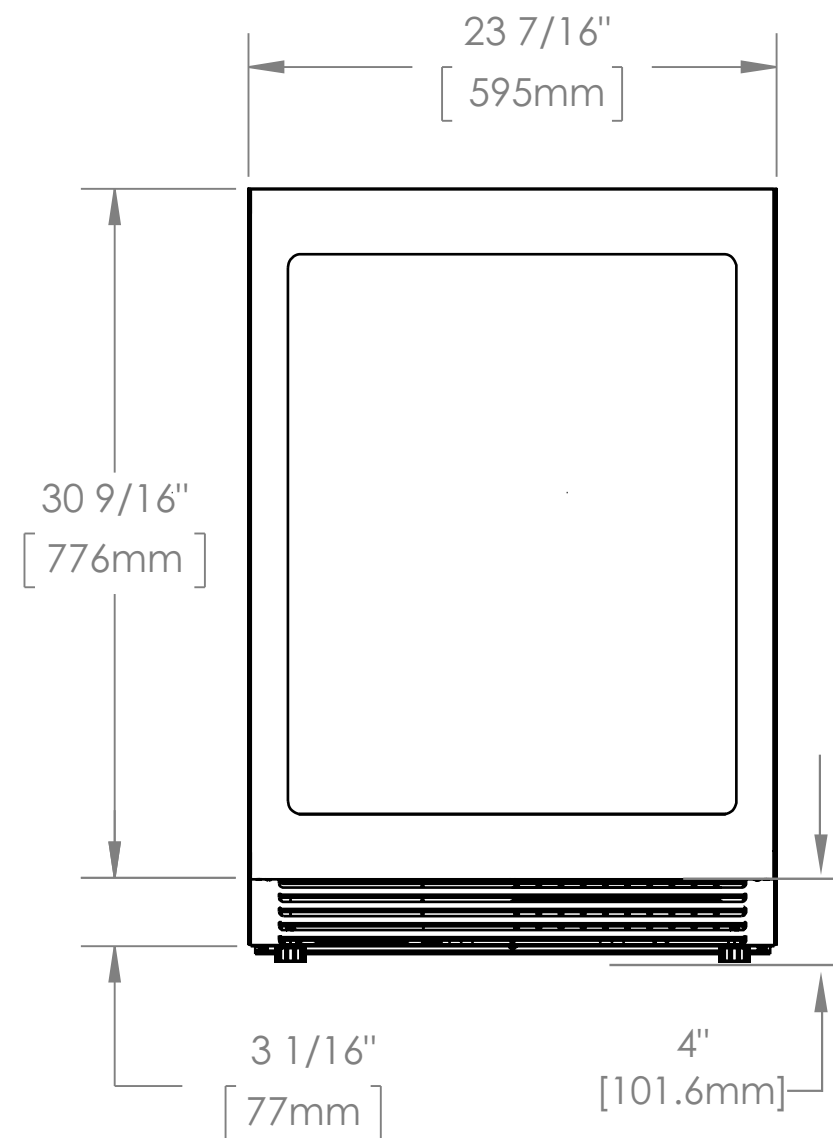

Depth dimension does not include panel & handle.

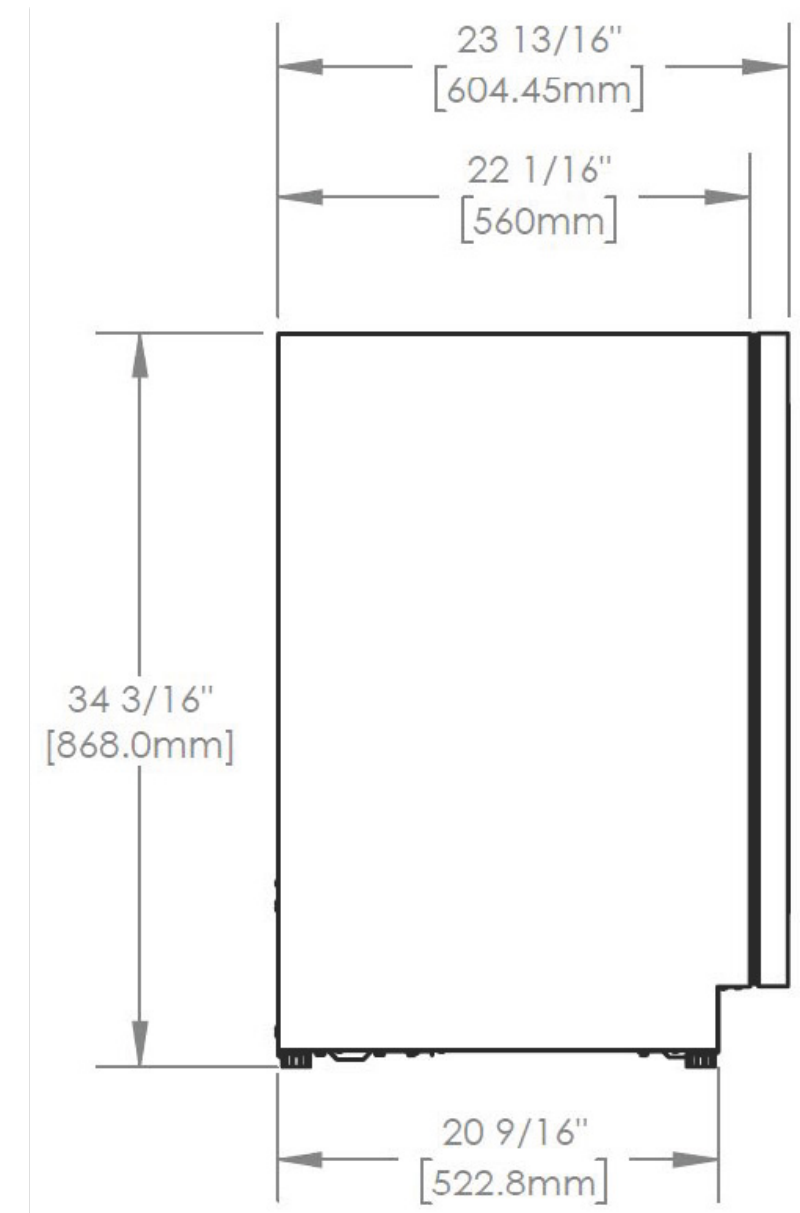

Open Door Dimensions

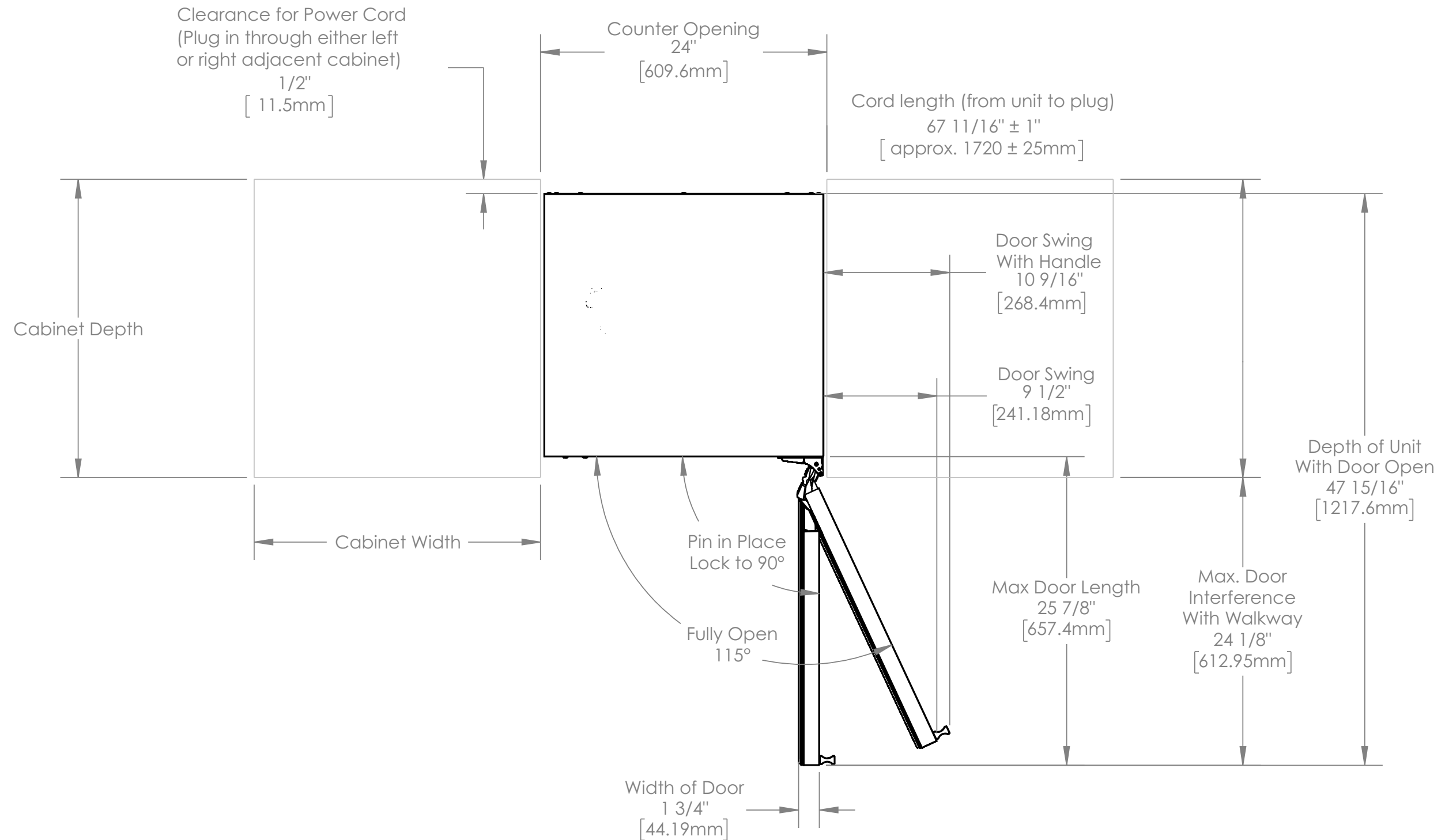

Electrical Outlet Rough-In Location

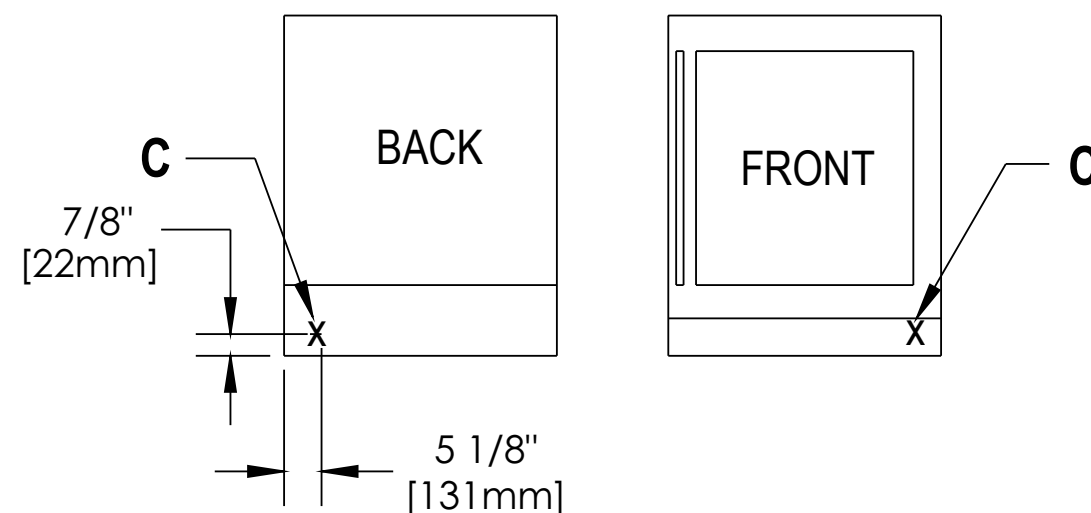
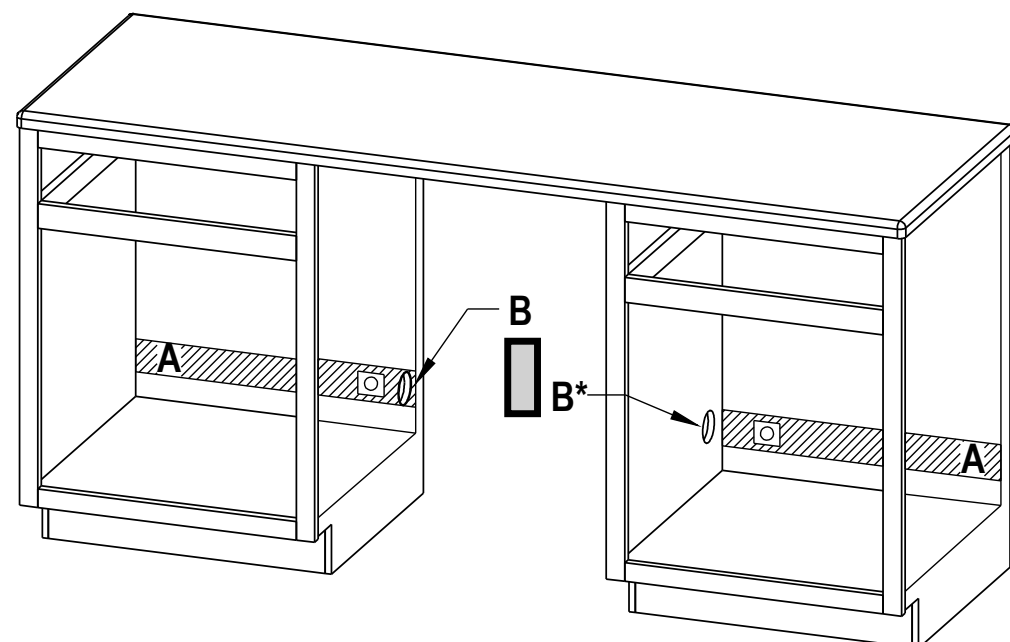

The power cord can be plugged in behind the unit; however for ease of cleaning and service, we recommend the power cord routed to the adjacent cabinet if possible.

A: Recommended area for installation connection.

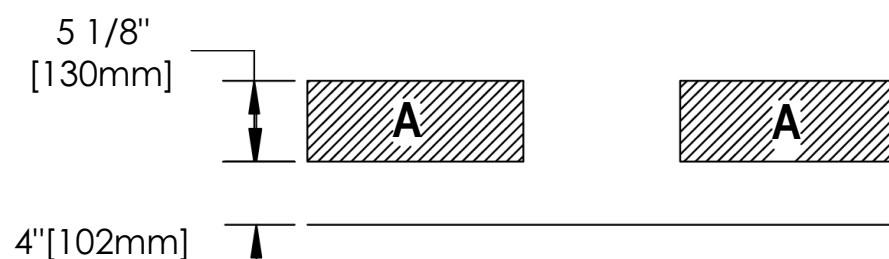

For flush installation it is recommended to plug in the power cord beside the unit, not directly behind.

B: To route power cord to outlet - a 2 1/2" [63mm] diameter hole through wall of the adjacent cabinet is recommended.

*The cabinet on the right hand side (when facing the front of the cabinet) is the preferred location to wire through.

C: Location of power cord is on the back left of the unit.

Rough-In & Product Dimensions

Rough-In Dimensions

A. Rough-In Width	24" [610mm]
B. Rough-In Height	34 1/2" [877mm] to 35 1/8" [892mm]
C. Rough-In Depth	24 7/8" [632mm]* 25" [635mm]**
D. Rough-In Depth Kickplate	21 13/16" [554mm]
E. Rough-In Kickplate Height	4" [101.6mm] to floor

Product Dimensions

F. Width	23 7/16" [595mm]
G. Height	34 3/16" [868mm] to 35" [888mm]
H. Depth	24 7/16" [620.5mm]* 24 9/16" [623.5mm]**
I. Depth to Kickplate	20 9/16" [523mm]
J. Kickplate Height	4" [101.6mm] to floor

*With 5/8" [16mm] thick panel.

**With 3/4" [19mm] thick panel.

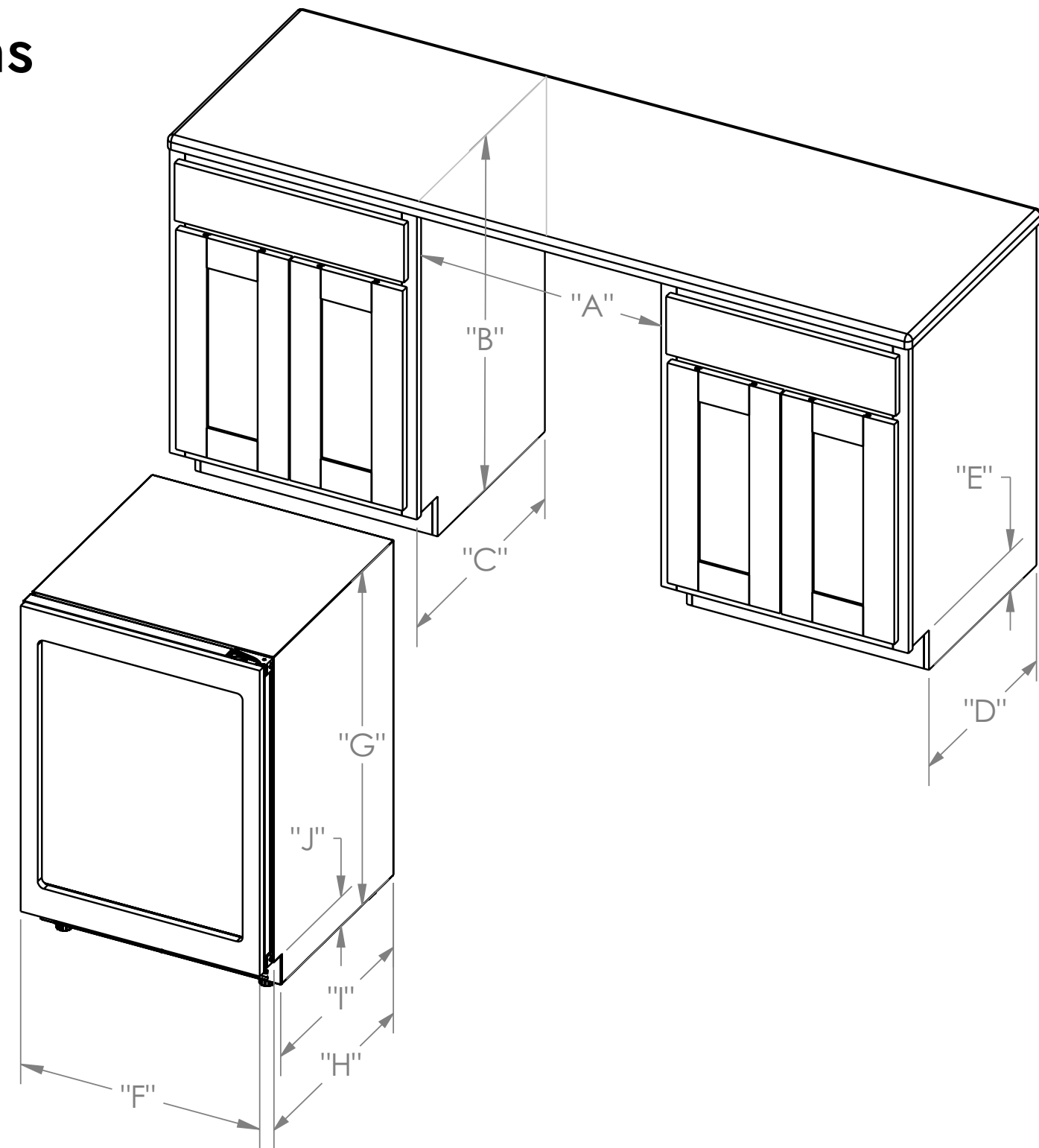

Panel Ready Frame Dimensions

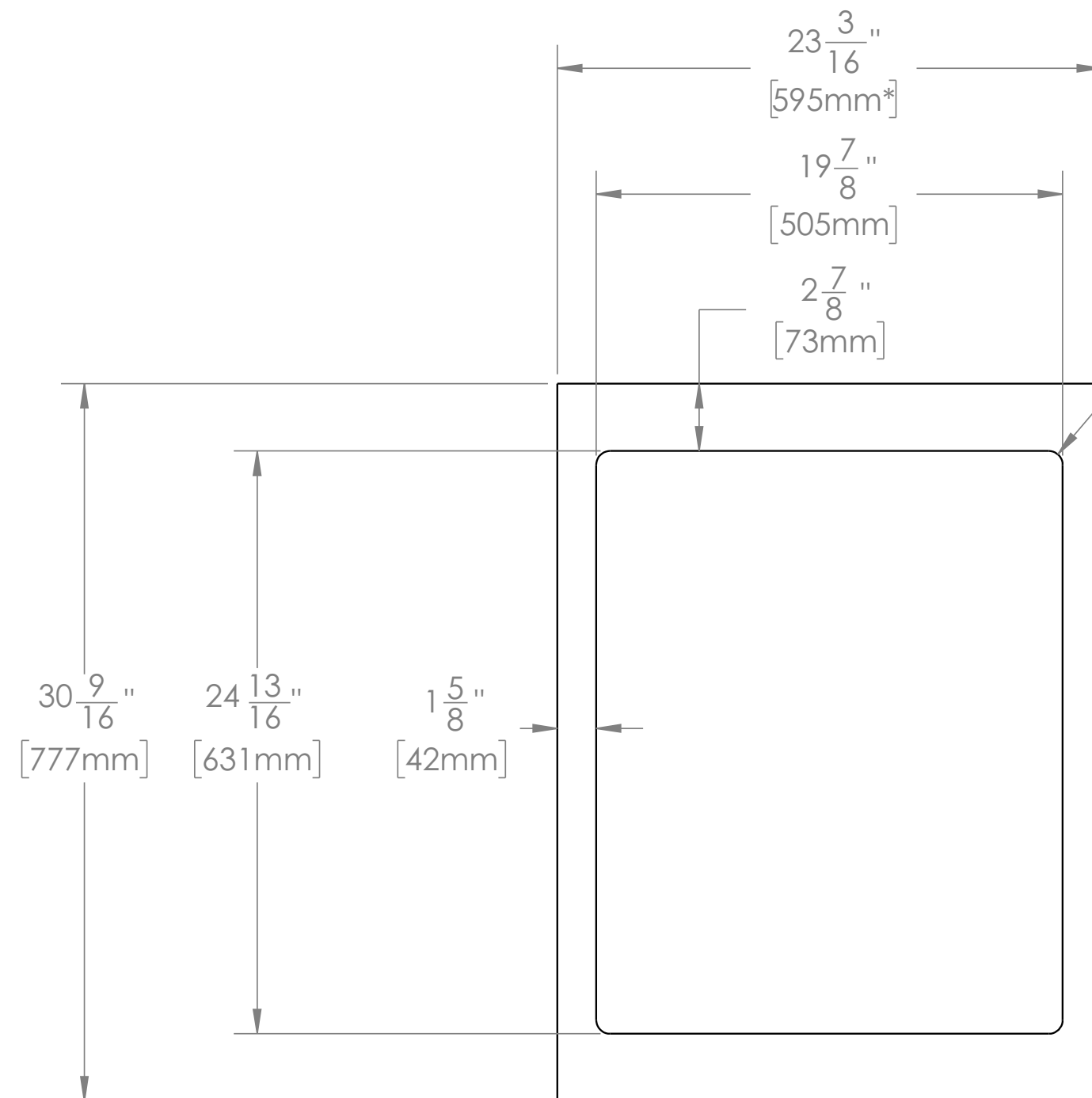

It is recommended the panel to be 590mm width but +/- 1mm tolerance is acceptable. Also, the aluminum frame can accommodate 5/8" thick panels as well, but will require shorter screws. Please discuss with your installer.

This appliance is designed to accommodate custom cabinet panels (either full or frame-style) by mounting onto the aluminum frame surrounding the humidity-controlled glass window.

$R\frac{9}{16}"$ X4
[15mm]

5/8"
Panel
Thickness
[16mm]

3/4"
Panel
Thickness
[19mm]

All dimensions provided in this document are nominal values and subject to standard manufacturing tolerances. Due to variations in production and assembly processes, actual measurements may differ slightly from the values stated. These variations are within industry-accepted tolerances and do not affect the intended functionality or performance of the product.